

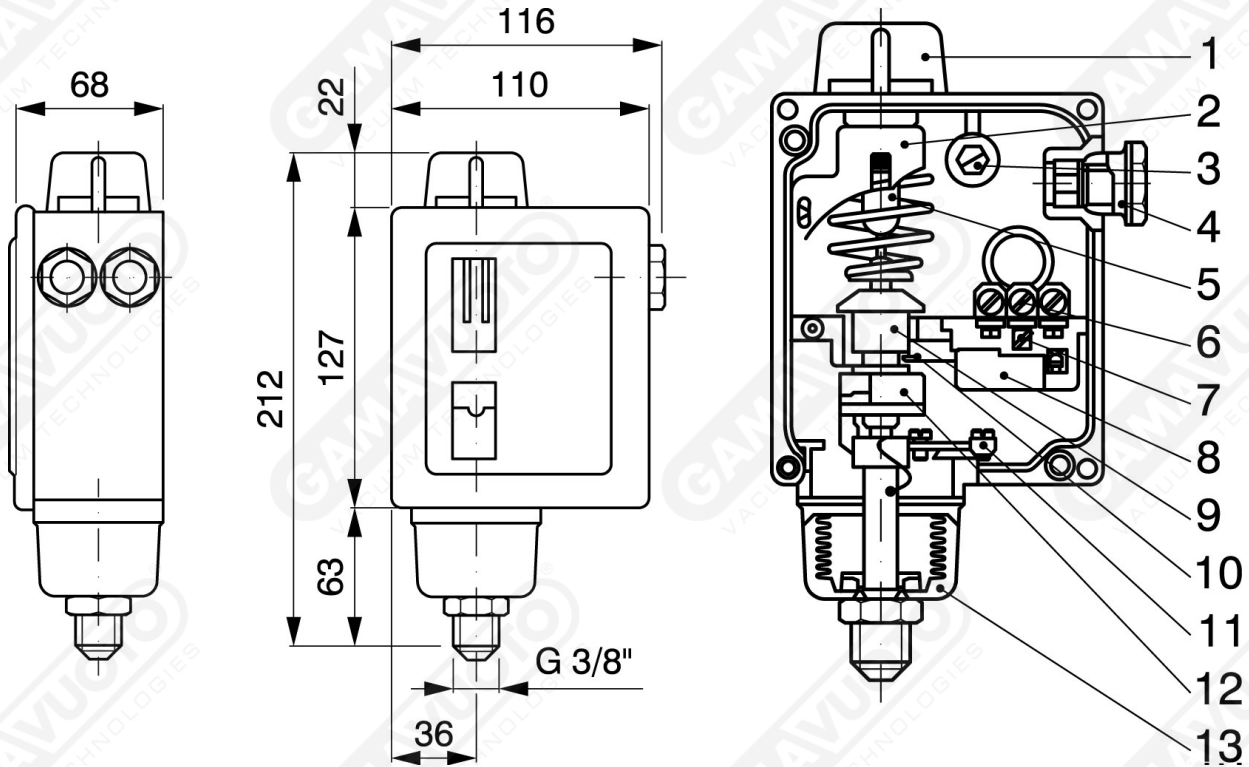

**Vacuum switches - pressure switches**

A pressure switch/vacuum switch can be defined as a switch which is controlled by pressure vacuum, and in which the position of the contacts depends on the pressure - vacuum in the "bellows", and on the value adjusted on the scale. The RT series covers a vast range of industrial applications in general, and is widely used in the sector of fluids, gaseous and liquid, as long as not corrosive.



**Art. SVC/RT**

Art. SVC/RT	Technical data
<b>Protection</b>	IP 66
<b>Working temperature</b>	-40 a 70° C
<b>Fluid temperature</b>	MAX 100° C
<b>Contact load</b>	C.A. non-inductive 10A, 400. Inductive 4A, 400 max.
<b>Max. peak current</b>	30 A
<b>C.C.</b>	12 W, 220 V
<b>Cable socket</b>	two pieces Pg 13.5
<b>Approved</b>	DEMKO, HEMKO, SEV and approved for ships
<b>Working pressure</b>	from -1 to 0 bar
<b>Differential</b>	from 90 to 400 mbar
<b>Contacts</b>	one in commutation contact

All pressure switches-vacuum switches built and dealt with by GAMAVUOTO are guaranteed by the safety regulations and the units of measure in force.

## Vacuum switch

1. Regulation knob
2. Main scale
3. Terminal
4. Threaded cable sockets PG 13.5
5. Range spring
6. Terminals
7. Main rod
8. Contact (17-4030)
9. Upper guide knob
10. Contact arm
11. Earth
12. Adjustment ring nut
13. Bellows